

Explanations

Specifications	584
Handing details	586
Product liability	588
Sales aids	590
German Standards (DIN)	592
General terms of sales	593
Guide to FSB	594
Sales Organisation	596
FSB-Edition	600

Sample specifications

Standard lever handle furniture

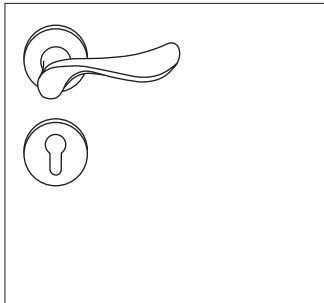

FSB lever handle furniture
Aluminium anodised
with 8 mm FSB Stabil spindle
for doors 40 mm thick

Bearings provided by lever
handle roses with lugs and
sliding bearings in glass-
fibre-reinforced black plastic

Escutcheons with
keyways

FSB moulded-to-the-hand
design 1020
Designed by Johannes Potente
Lever handle rose FSB 1131
Escutcheon FSB 1735

AGL® heavy-duty furniture

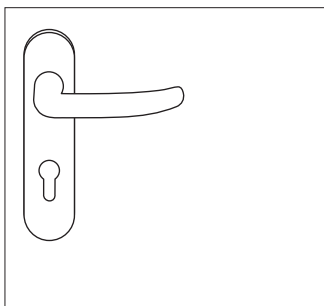

FSB lever handle furniture
AGL Stainless Steel with
8 mm FSB Stabil spindle for
doors 40 mm thick

Handles permanently supported
in precision-fit, maintenance-
free compensating bearings on
FSB backplates 185 x 45 mm

with reinforcement lugs,
concealed fixing on both sides
Fixing centres 72 mm

FSB design 7223 04
Based on a design by Max Bill
reworked by Johannes Potente

FSB lever handle furniture

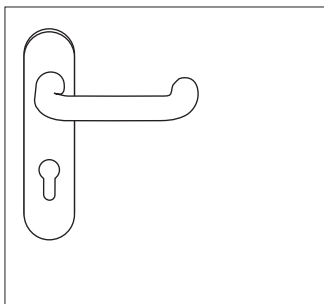

FSB lever handle furniture
for smoke and fire doors
to DIN 18 273

Aluminium anodised
with 9mm FSB Stabil spindle
for doors 40 mm thick

Handles permanently attached
to FSB backplates 185 x 45 mm

supplied with reinforcement
lugs, concealed fixing on
both sides
Fixing centres 72 mm

FSB design 7646 04
original FSB works design

Lever handle furniture for framed doors

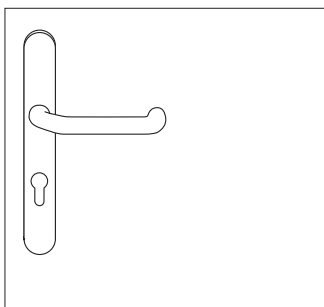

FSB lever handle furniture
for framed doors in
aluminium anodised
with 8 mm FSB solid spindle
for doors 40 mm thick

Handles permanently attached
to oval backplates 245 x 35 mm

with reinforcement lugs,
sliding bearings in black pla-
stic, concealed fixing on both
sides Fixing centres 72 mm

FSB design 7816
original FSB works design

Recommendation

In describing our products at such length, we have sought to stress their distinctive “personalities”, i.e. the factors that set them apart from their market rivals.

Whether you are a briefing architect, a consultant joiner, a builders hardware whole-saler or an “enlightened” enduser,

to ensure an FSB product is absolutely right for a given door or window you should heed all the specific “traits” accorded that product.

Indicated on these two pages are examples of how to ensure that the FSB products chosen are the most suitable for German customers.

Security furniture

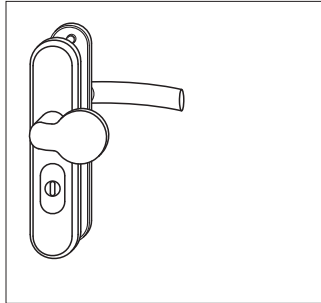

FSB security furniture
Security Class 2-ZA
aluminium . . . anodised
FSB multilayer construction
technique
with cylinder guard for projec-
tions of 8 - 16 mm
FSB Stabil spindle secured
in neck of knob
Fixing distance 72 mm EPC

FSB design 7384 5510
Knob and lever handle
Designed by Hartmut Weise

Pull handle (door pull)

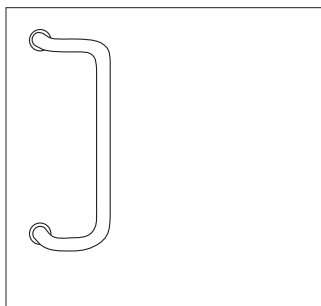

FSB pull handle in tubular
material
e.g. brass polished waxed
Length of handle 350 mm
Handle diameter 30 mm
with support roses for greater
stability on the face of the door
Back-to-back fixing 1

FSB design 6662 38

Window handle

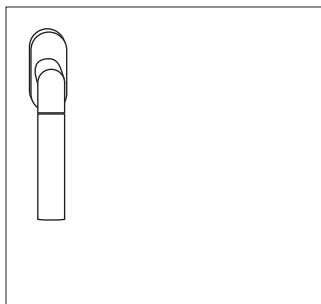

FSB window handle
cast aluminium and
grey/black thermoplastic
RAL-certified click-stop
mechanism
enduringly smooth action
audibly clicks into position
all-over basket-arch rose

Concealed fixing
with reinforcement lugs,
diameter 10 mm

FSB design 3778
produced by
Christoph Ingenhoven

Door stop

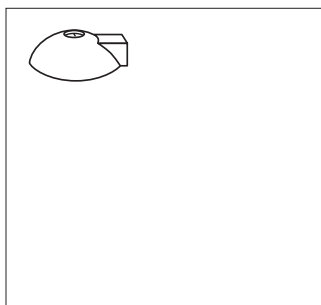

FSB floor-fitted door stop
stainless steel . . .
diameter 70 mm
complete with fastenings

FSB design 3884 00
original FSB works design

Handing details

Lever handle furniture for doors DIN l.h., inward opening

Male handle points right, female handle points left

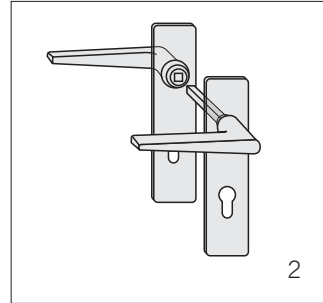
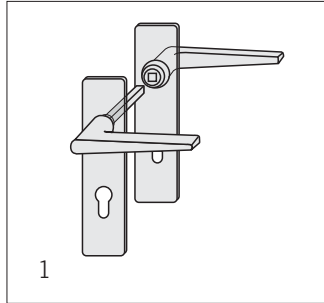

Lever handle furniture for doors DIN r.h., inward opening

Male handle points left, female handle points right

Lever furniture with dead knob for doors DIN l.h., inward opening

Female handle points left

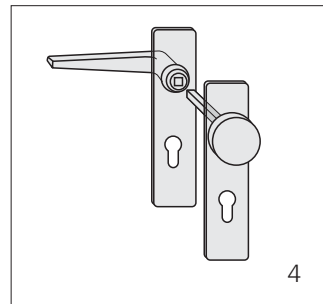
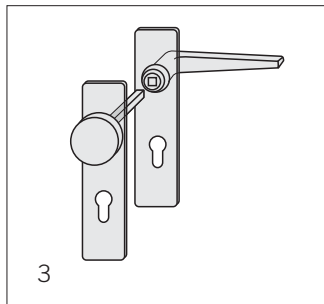

Lever furniture with dead knob for doors DIN r.h., inward opening

Female handle points right

Bathroom/WC furniture for doors DIN l.h., inward opening

Male handle points right, with WC perforation, female handle points left, with thumbturn

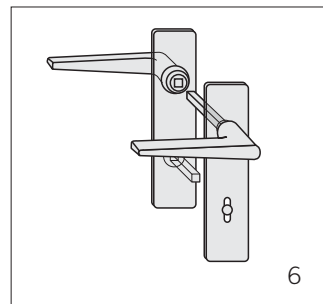
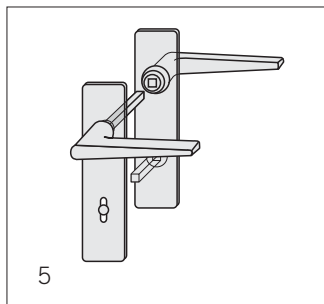

Bathroom/WC furniture for doors DIN r.h., inward opening

Male handle points left, with WC perforation, female handle points right, with thumbturn

DIN left hand inward opening

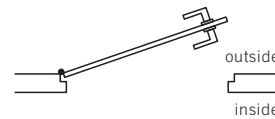
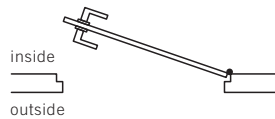

DIN right hand outward opening

DIN right hand inward opening

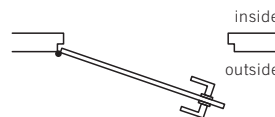
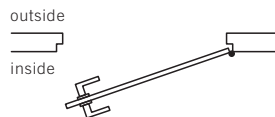

DIN left hand outward opening

Explanation:

The German specifications DIN right hand respective DIN left hand refer to the positioning of the things on the opening face of the door.

Lever handle furniture for doors DIN l.h., inward opening

Male handle points right, female handle points left

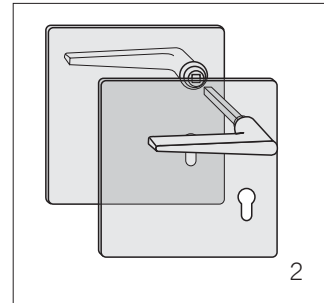
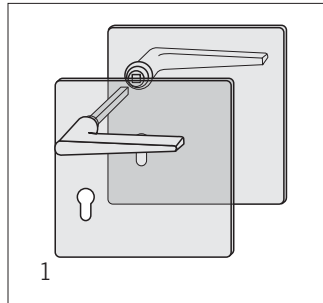

Lever handle furniture for doors DIN r.h., inward opening

Male handle points left, female handle points right

Lever furniture with dead knob for doors DIN l.h., inward opening

Female handle points left

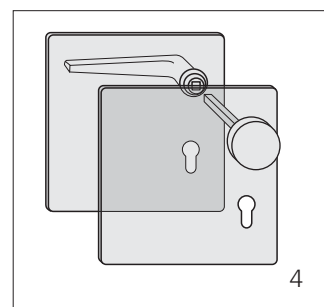
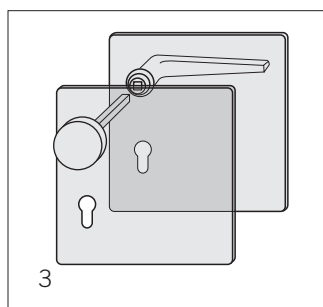

Lever furniture with dead knob for doors DIN r.h., inward opening

Female handle points right

Bathroom/WC furniture for doors DIN l.h., inward opening

Male handle points right, with WC perforation, female handle points left, with thumbturn.

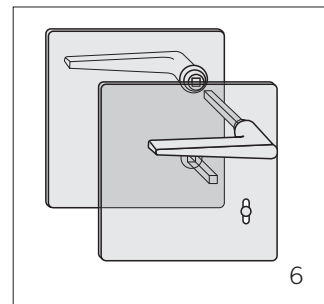
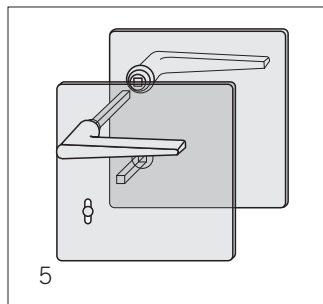

Bathroom/WC furniture for doors DIN r.h., inward opening

Male handle points left, with WC perforation, female handle points right, with thumbturn.

DIN left hand inward opening

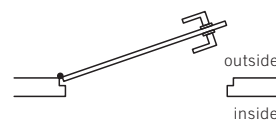
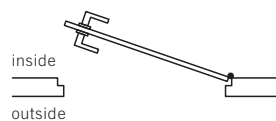

DIN right hand outward opening

DIN right hand inward opening

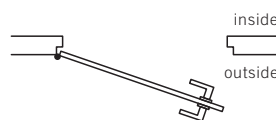
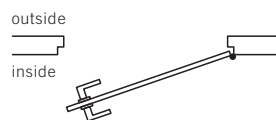

DIN left hand outward opening

Doors are either right or left hand, relative to which way they open. When ordering lever furniture with dead knob or if you require the spindle element to be located on the outside, you should specify left or right hand.

About product liability

Under the Product Liability Act, FSB is liable for damage caused by faulty products, the precondition being that, in the selection, installation and use of the goods, all the applicable regulations set down in the FSB manual shall have been complied with.

We would additionally like to point out that what the law defines as product liability and what the end user actually expects of a product can be two radically different things. Door and window handles, after all, are in the first instance “tools” for opening and closing doors and windows. However beautiful they might be, such tools still remain subject to the laws of wear and tear. Though prime materials are used, production is organised to ISO 9001, and the company has successfully undergone an EU “eco-audit” (1996) and been certificated to ISO 14001 (1997), the laws of physics will inevitably manifest themselves to the end user in the form of wear and tear.

The main definitions and regulations are recapitulated in the following.

1.0 Product definitions

1.1 Lever handles and accessories

Lever handles and their accessories are implements with which to open and close doors. They do this in concert with the door frame, the door's hinges, the door leaf, the lock, and the cylinder, and all these components need to be properly synchronized. It's no use trying to use a lever handle to open a door if the door is locked, for instance, the only exception to this being the special mechanisms featured on panic doors.

1.2 Tubular handles

The same applies to tubular handles. The door frame, door hinges, door leaf and other closing devices such as door closers need to be compatible with one another.

1.3 Window handles and accessories

Again, window handles are but one element of the window. The method of closure will generally determine which type of handle is appropriate.

2.0 Improper use

Lever handles, pull handles and window handles and sliding ventilators are subject comparatively frequently to improper use, and this can lead sooner or later to damage for which the manufacturer can no longer be held responsible. Typical examples:

- Lever handles are used as supports, especially when on doors at the base of steep stairs.
- Doors are used as a sort of roundabout by children, the handles serving as the main source of support.
- In the absence of door stops, lever handles and pull handles bang against the wall.
- Lever handles and pull handles are used to hang heavy objects on.

3.0 Product Performance

Notions of product performance are only codified in norms to a very limited degree. For the most part, they are the up-shot of many years of experience and are by now common property in the builders hardware trade. FSB keeps faith with these general informal standards. The norms listed below apply for special performance requirements.

- **DIN 18 255**
This norm sets general standards for door furniture and accessories.
- **DIN 18 273**
This norm sets out limits specifically for firecheck and smoke stop doors.
- **DIN 18 257**
This norm lays down minimum requirements for security furniture.

FSB products are constantly evolving, and production is subject to continuous quality control. We reserve the right to make technical modifications.

4.0 Product maintenance

Most FSB products are “implementations” for the opening and closing of doors and windows. Sooner or later, depending on what they are made of and where they are fitted, they will inevitably begin to show signs of wear. The properties of the various materials can be summarized as follows:

4.1 Aluminium

Aluminium has performed admirably in everyday use for many decades. The metal is protected by a tough anodised coating. Surface scratch marks in no way impair the operating efficiency of the furniture but simply denote the passing of time.

4.2 AluGrey

AluGrey is new to the FSB programme and boasts a greater surface hardness and resistance to wear than standard aluminium. On account of the above-mentioned properties, noticeable signs of use are slow to materialise under normal circumstances but, even so, cannot be ruled out completely in the long term, though the functioning of the hardware remains unaffected whatever the case.

4.3 Stainless steel

Stainless steel is commonly regarded as being indestructible. In fact, even stainless steel can develop scratches and traces of rust. This latter is the phenomenon known as 'flash rust', which can be removed with the aid of standard cleansing agents.

4.4 Brass

Much has already been said in the FSB manual regarding the properties of brass. Whereas aluminium is more or less a pure metal, brass is an alloy with tendencies towards corrosion. We would therefore like to emphasize once again here that only regularly cleaned brass components without lacquer retain their initial allure. Once the coating of the lacquered version has been breached, unsightly corrosion sets in, and this can only be reversed in our factory after a laborious stripping operation.

4.5 Aluminium + colour

Coloured FSB lever handles are generally given a flexible colour membrane approx. 250 microns thick that is long-lived given correct use. Contact with sharp objects may lead to some denting.

4.6 Upkeep

All FSB products are largely maintenance-free. Once fitted, however, FSB nevertheless recommends checking at regular intervals that they are properly positioned and that screw fastenings are secure. Water and a soft cloth only should be used to keep FSB hardware clean.

5.0 Requisite information and instructions

Relevant information and instructions can be gleaned from the following material:

For stockists, architects and consultants: catalogues with all the necessary detailed descriptions.

For installers: besides catalogues - fitting instructions and templates and, where necessary, technical drawings.

For end users: fitting instructions, templates, and instructions for use and - in specific instances - care, all included with products.

To ensure the correct functioning of door and window furniture,

architects and designers are urged to bear in mind where and under what conditions the furniture is going to be in use and to select accordingly. Any queries should be addressed to the trade wholesalers, the FSB External Service, or FSB itself.

the sales trade is urged to rigorously double check the specifications provided by architects, designers and clients so as to ensure the compatibility of these specifications with those of the furniture selected.

installers are urged to make sure they receive from the sales trade all the products information and fitting and maintenance instructions needed for them to be able to fit the furniture correctly and pass on any relevant information to the customer.

Sales aids

You may be wondering why it is we have so much to say on the subject of sales aids. Well, the fact is that we in no way regard this as a peripheral issue. Builder's hardware, after all, is not replaced that frequently and is expected to perform day in, day out for a great many years. Opting for the wrong product – wrong in terms of quality, design or, indeed, profit margin – can take a long time to put right. Which is why it is important to support the decision-making process from an early stage so as to be able, at the decisive moment, to guide the customer's aspirations towards the right product. The enlightened purchaser and customer expects to find sensible displays, readily assimilable catalogue material and cogent sales arguments at the "point of sale". FSB has always endeavoured to oblige.

1. Displays and specimen boards

We at FSB do not go along with turning display areas into supermarket-type affairs and confronting the end-user with a hotchpotch of hardware. For this reason, we have developed an all-in display set-up which is so variable that adapting it to a given spatial configuration is no trouble.

As a means of keeping key elements of the FSB programme well apart from competitors' offerings even in the most cramped of spaces, we have additionally come up with a three-sided rotating merchandiser. This allows upwards of 35 FSB products to be excellently exhibited on half a square metre of floor space at most. There is also a special rotating merchandiser for FSB's wide range of main entrance door fittings.

Our specimen boards sport our corporate shade of grey. Metal of all colours stand out well against this background. Fittings are combined with special lock mechanisms so the customer can get a feel of how they work in practice. Specimen boards come in both standard and custom sizes.

For architects, however, specimen boards are often not enough. Instead, they want to see how the fitting acts in conjunction with lock and cylinder on a small door element. We supply specimen blocks for just this purpose.

We have also developed a bespoke specimen case for all those who like (or have) to travel with the FSB programme. It can be bought or, in individual instances, hired. FSB's Field Service will explain the modalities.



2. Manuals and Prospectuses





As you may have noticed, for many years now FSB has been putting a lot of effort into its manuals and prospectuses (a case in point being what you are reading now). And, to our great joy, the trade and public both definitely appear to have appreciated our efforts. This has inspired us to further expand our range of written sales aids and informational material.



3. Sales arguments

All retailers know (and dread) the ritual customer question that goes “And what would you recommend?” The temptation is to respond with platitudes such as “Beauty is in the eye of the beholder” or by attempting to explain what is currently in fashion or selling particularly well. But are these good or at least adequate sales arguments?

We don’t think so. And, in the light of this, we have published a whole series of books - the FSB Edition - that delve into virtually every aspect of “handle culture”. Anyone wishing to extend his or her repertoire of sales arguments is urged to consult them. Apart from anything else, they set forth the best sales argument of all, the “Four Rules of Grip” identified by FSB, which allow the end-user to adopt a hands-on approach to deciding which handle to buy:

-  Thumb rest
-  Forefinger furrow
-  Support for the ball of the thumb
-  Gripping volume



German Standards (DIN)

Without laying any claim to exhaustiveness, set out below are a selection of German Industrial (DIN) Standards with a bearing on doors and windows:

DIN 107
Building construction; identification of right and left side

DIN 4102 - Supplement 1
Fire behaviour of building materials and components; tables of contents

DIN 4102-5
Fire Behaviour of Building Materials and Building Components; Fire Barriers, Barriers in Lift Wells and Glazings Resistant against Fire; Definitions, Requirements and Tests

DIN 4102-13
Fire behaviour of building materials and elements; fire resistant glazing; concepts, requirements and testing

DIN 4102-18
Fire behaviour of building materials and components; fire barriers, verification of automatic closure (continuous performance test)

DIN 1080-1
Terms, Symbols and Units Used in Civil Engineering; Principles

DIN 18 055
Windows; air permeability of joints, water tightness and mechanical strain; requirements and testing

DIN 18 082-1
Fire barriers; steel doors T 30-1; Construction type A

DIN 18 095-1
Smoke control doors; concepts and requirements

DIN 18 095-2
Smoke control doors; type testing for durability and leakage

DIN 18 100
Doors; wall openings for dimensions in accordance with DIN 4172

DIN 18 101
Doors; doors for residential buildings; sizes of door leaves, position of hinges and lock, interdependence of dimensions

DIN 18 111-1
Door frames; steel door frames; standard door frames for rebated doors

DIN 18 250
Locks; mortice locks for fire barriers; single latch bolt lock

DIN 18 251
Locks; mortice locks for doors

DIN 18 252
Locking cylinders for door locks; terminology

DIN 18 254
Profile cylinders with pin tumblers for door locks; dimensions, materials, requirements, testing, labelling and marking

DIN 18 255
Building hardware; door handles, door plates and door roses; concepts and definitions, dimensions, requirements

DIN 18 257
Building hardware; security door plates, concepts and definitions, dimensions, requirements, testing and labelling

DIN 18 268
Building hardware; hinges for doors; reference-lines for hinges

DIN 18 273
Building hardware; lever handle units for fire doors and smoke control doors; concepts and definitions, dimensions, requirements and testing

DIN 18 357
Contract procedure for building works; Part C: General technical specifications for building works; mounting of window and door fittings

DIN 18 361
Construction contract procedures (VOB) - Part C: General technical specifications in construction contracts (ATV); Glazing

DIN 32 617
Letter-boxes; requirements, testing and arrangement

DIN 58 125
School buildings, structural requirements for the prevention of accidents

DIN 68 706, Part 1
Plywood-doors; concepts, priority sizes, construction characteristics for interior doors

DIN EN 179
Building hardware - Emergency exit devices operated by a lever handle or push pad - Requirements and test methods

DIN EN 1125
Building hardware - Panic exit devices operated by a horizontal bar - Requirements and test methods

DIN EN 1303
Building hardware - Cylinders for locks - Requirements and test methods

DIN V ENV 1627
Windows, doors, barriers - Anti-burglar devices - Requirements and classification

DIN V ENV 1628
Windows, doors, barriers - Anti-burglar devices - Test methods for establishing resistance under static loads

DIN V ENV 1629
Windows, doors, barriers - Anti-burglar devices - Test methods for establishing resistance under dynamic loads

DIN V ENV 1630
Windows, doors, barriers - Anti-burglar devices - Test methods for establishing resistance to manual attempts at intrusion

DIN EN 1670
Corrosion behaviour - Requirements and test methods

DIN EN 1906
Building hardware, lever handles and doorknobs - Requirements and test methods

DIN EN 12 209
Mechanically operated locks and striking plates - Requirements and test methods

DIN EN 13 724
Residential letter boxes - requirements, inspection, installation

General terms of sale

1. General

The following Terms of Sale represent the exclusive basis for all quotations and contracts; any deviating terms of the Customer, unless explicitly acknowledged in writing, shall be deemed invalid.

2. Quotations

All quotations remain subject to confirmation unless explicitly stipulated as binding or fixed. A contract of sale shall be constituted only upon our written confirmation of order.

3. Delivery and Passage of Risk

Shipment shall be made at the risk and expense of the Customer. The risk passes to the Customer when goods are delivered to the shipping or forwarding agent.

4. Delivery Dates

The delivery dates quoted indicate the foreseeable delivery dates with which we shall endeavour to comply.

5. Prices

Unless other agreements regarding pricing have been made, the prices applicable on the date of delivery shall apply. All prices shall be subject to value-added tax, VAT, and are quoted ex warehouse Brakel, excluding packaging. Packing shall be charged at cost. Tools for which prorated payments have been received shall remain our property.

6. Payment, Offset and Withholding, Return Shipment

Our invoices shall be payable 14 days after date of invoice at 2% discount or 30 days after date of invoice net. Invoice sums less than EUR 50.00 shall be payable net immediately. In the event of overdue payment, we shall be entitled to charge interest at the over-draught rate applicable at that time, and at least 3% above the basic interest rate in accordance with the BGB

(Civil Code) § 247. If, after an order has been placed, we become aware of circumstances which give us good cause to doubt the creditworthiness of the Customer, we shall be entitled to deliver this order subject to cash in advance only and to make the delivery of other orders subject to their prior payment. The Customer shall be entitled to only offset counterclaims which have been legally established or are otherwise undisputed and may exercise a withholding right only in respect to such claims that are based on the same contract. The Customer shall be entitled to return goods only subject to express prior agreement. Such return shipments are subject to a deduction of at least 30% of the value of the goods to compensate for expenses.

7. Retention of Title

The products delivered (reserved goods) shall remain our property until payment in full of the purchase price and all existing and future claims arising from the business relations with the Customer. This shall also apply in cases in which individual or all claims have been consolidated into one single invoice and balanced and approved. The Customer shall be entitled to sell the reserved goods in the due course of business provided he meets his contractual obligations. Otherwise we shall be entitled to require the surrender of the reserved goods; in this case, the Customer has no right of possession. We shall then be entitled, without prejudice towards the Customer's obligation of payment, to sell the re-possessed goods and to credit the Customer with any surplus. At the time of purchase of the reserved goods, the Customer shall at that point in time assign to us all claims arising from the resale which accrue to him against his customers. Subject to revocation, the Customer

shall be authorised to collect the assigned claims; upon our demand, however, he shall notify us without delay and in full of the amount of these claims and the names of his customers. If, in the event of a delivery by the manufacturer, a bill debt is constituted, the retention of title shall expire only after the bill has been redeemed. Should the redeemable value of existing securities surpass the secured claims by more than 10%, we shall be obliged, if so demanded by the Customer, to release securities of our own choice. We shall be entitled to repudiate a contract if an application to open bankruptcy proceedings has been made with respect to the Customer's assets.

8. Published Details

Unless explicitly described as binding, all details and illustrations contained in our brochures and catalogues shall merely represent approximate values common in the industry. The onus shall rest on the Customer to undertake his own examination as to whether the goods are suitable for the intended purpose.

9. Warranty

In the event of complaints regarding recognisable defects, wrong deliveries or substantial differences in quantity, notification must be made to us without delay and in writing at the latest within ten days of delivery of the goods. If the Customer does not make notification of any defects within this period, the goods shall be deemed to have been approved free of defects. Relevant for the purposes of determining whether the condition of the merchandise is in compliance with the contract is the point in time at which risk passes to the Customer as per Article 3. Concealed defects must be notified in writing without delay upon their discovery. We must be given the

opportunity to verify any defect notified. We shall grant a warranty for freedom from defects as defined by the state of the art for a period of two years from the date of delivery. Excluded from warranty are damages resulting from wear and tear, improper handling, faulty assembly or any servicing. The same applies for defects that only negligibly reduce the value or functionality of the merchandise. In the event of a justified and timely complaint, we shall, at our discretion, undertake either improvement or replacement of the goods; all further claims, in particular claims for consequential damage, shall be excluded. In the event that such improvement or replacement fails, the Customer shall retain the right to demand a reduction of the purchase price or rescission of the contract.

10. Place of Performance

and Court of Jurisdiction
Place of performance, place of payment and court of jurisdiction, including that for legal actions on bills of exchange or checks, shall be, as far as admissible, Brakel. This contract shall be governed exclusively by German law. The United Nations Convention of 11.04.1980 on Contracts for the International Sale of Goods (CISG - "Vienna Sales Convention") shall not apply.

11. Closing Provision

The legal invalidity of individual provisions shall not otherwise affect the enforceability of these General Terms and Conditions of Sale.

How to reach FSB



Brakel is situated in the south-easternmost corner of the German federal state of North-Rhine Westphalia. Geographically speaking, it is where the Egge mountains merge with the Weserberg hills.



Paderborn is connected with Berlin, London, Munich, Paris and Stuttgart, etc. The distance of the ICE-railway station Kassel-Wilhelmshöhe is about 55 minutes by car to Brakel.

The distances to the most important German airports in km are:

Düsseldorf	about 200 km,
Frankfurt	about 220 km,
Hannover	about 120 km.

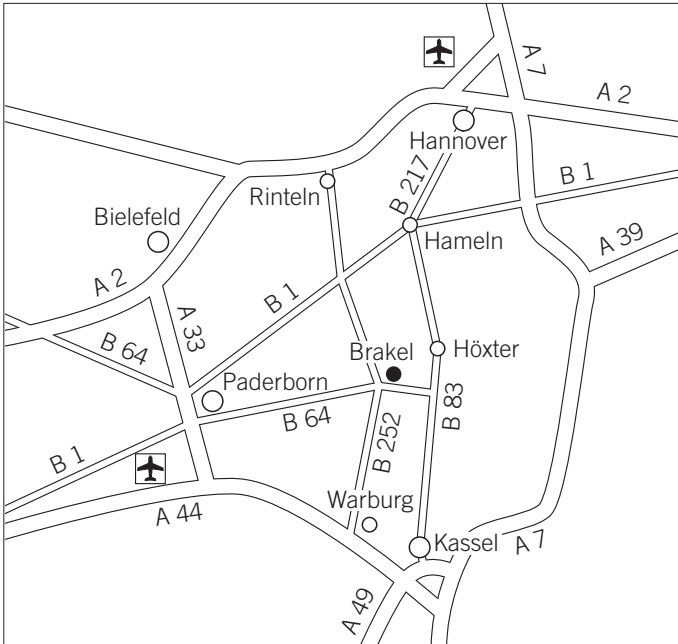

When going by car from the north, you'll come to Brakel via motorway, Hannover-Dortmund, exit point Rinteln, picking up then the route from Rinteln-Barntrup-Blomberg to Brakel. The distance from Rinteln to Brakel is about 90 km.

When coming from the south, leave the motorway Kassel-Dortmund at the exit point Warburg/Brakel driving then from Warburg over Peckelsheim, Siddessen and Rheder about 35 km to Brakel.

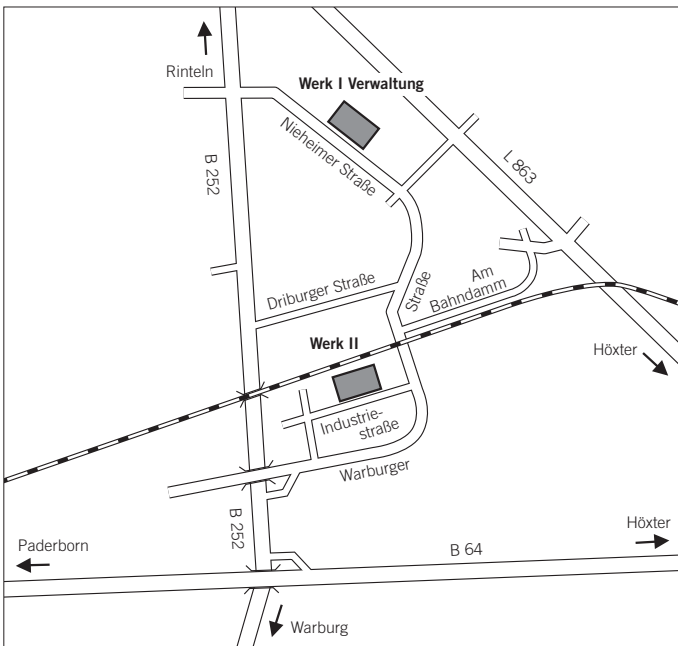

FSB has two production sites in Brakel.

Central administration is located together with the aluminium foundry and development units at Nieheimer Straße 38.

Facilities II and III are housed along with the logistics centre at Industriestraße 12 on the Brakel industrial estate.

Sales Organisation Germany



Field Service for Hardware,
ErgoSystem, EZK:

1
Klaus-Dieter Heib
Klaus-Groth-Straße 8h
25524 Itzehoe
Phone +49 4821 93795
94239
Fax +49 4821 94248
www.kd-heib.de
info@kd-heib.de

FSB Project Consultant
Bernward Niestegge
Friedrich-Ebert-Straße 2
27374 Visselhövede
Phone +49 4262 957558
Fax +49 4262 957559
bernward.niestegge@fsb.de

2
FSB Project Consultant
Thorsten Schmidt
Oberlether Straße 2
26203 Wardenburg
Phone +49 4407 716415
Fax +49 4407 716416
thorsten.schmidt@fsb.de

3
Frank Maibohm
Demminer Landstraße 6
17389 Anklam
Phone +49 3971 210636
Fax +49 3971 210642
frank_maibohm@t-online.de

4
Ludger Hammelbeck
Eichenweg 34
59556 Lippstadt
Phone +49 2941 9680080
Fax +49 2941 9680089
www.beschlagkonzepte.de
l.hammelbeck@
beschlagkonzepte.de

4 + 8
FSB Architectual Consultant
Franz-Josef Hund
Rudolf-Harbig-Straße 7
48301 Nottuln
Phone +49 2502 222577
Fax +49 2502 222578
franz-josef.hund@fsb.de

<p>5 FSB Project Consultant Joachim Wegener In den Gänseköpfen 18 31188 Holle Phone +49 5062 963274 Fax +49 5062 963367 joachim.wegener@fsb.de</p>	<p>Adalbert Eulenstein Gräfenthaler Straße 4 07330 Probstzella Phone +49 36735 70790 Fax +49 36735 70790 eulenstein@kh-peters.de</p>	<p>Technical assistance: 1, 2, 3, 5 Holger Mannigel Neue Straße 4 19258 Bahlen Portable +49 151 17448482 Fax +49 5272 608-336 holger.mannigel@fsb.de</p>	<p>General contact ErgoSystem Jürgen Klenke Key Account Manager Nieheimer Straße 38 33034 Brakel Phone +49 5272 608-296 Fax +49 5272 608-354 juergen.klenke@fsb.de</p>
<p>6 FSB Project Consultant Jens-Uwe Fuchs Albert-Schweitzer-Straße 5 39126 Magdeburg Phone +49 391 2545672 Fax +49 391 2545673 jens-uwe.fuchs@fsb.de</p>	<p>12 FSB Project Consultant Jörg Ruhland Ernst-Thälmann-Straße 62 04420 Markranstädt Phone +49 34205 418250 Fax +49 34205 418251 joerg.ruhland@fsb.de</p>	<p>2, 4, 5, 8, 9, 10, 13 Antonius Herting Orthagen 8 59581 Warstein Portable +49 160 4768446 Fax +49 5272 608-309 antonius.herting@fsb.de</p>	<p>Frank Diederichs Sales departement Nieheimer Straße 38 33034 Brakel Phone +49 5272 608-281 Fax +49 5272 608-381 frank.diederichs@fsb.de</p>
<p>7 Bernhard Möhring Behlertstraße 27 A 14469 Potsdam Phone +49 331 74036-0 Fax +49 331 74036-16 bm.@moehring-wv.de</p>	<p>13 Arnold Reinstädtler Inh. Alexander Reinstädtler Kirchendell 39 66787 Wadgassen-Differten Phone +49 6834 9601-0 Fax +49 6834 9601-18 www.reinstaedtler.de info@reinstaedtler.de</p>	<p>5, 6, 7, 11, 12 Uwe Drasdo Am Birnengarten 72 A 39116 Magdeburg Portable +49 151 17448534 Fax +49 5272 608-338 uwe.drasdo@fsb.de</p>	<p>Angelika Tubbesing Sales departement Nieheimer Straße 38 33034 Brakel Phone +49 5272 608-254 Fax +49 5272 608-354 angelika.tubbesing@fsb.de</p>
<p>8 FSB Project Consultant Olaf Kahlen Überhöfer Feld 8 51503 Rösrath Phone +49 2205 9198414 Fax +49 2205 9198415 olaf.kahlen@fsb.de</p>	<p>14 FSB Project Consultant Matthias Rickert Am Kasernenplatz 4b 96487 Dörfles - Esbach Phone +49 9561 2343020 Fax +49 9561 2343022 matthias.rickert@fsb.de</p>	<p>13, 15, 16 Lars Weber Liegnitzerstr. 6 72213 Altensteig-Walldorf Portable +49 175 2611204 Fax +49 5272 608-308 lars.weber@fsb.de</p>	<p>EZK Matthias Mildner Electronical division Key Account Manager Leipziger Ring 281 63110 Rodgau Phone +49 6106 26798-89 Fax +49 6106 26798-90 matthias.mildner@fsb.de</p>
<p>9 FSB Project Consultant Rolf Geppert Auf dem Hähnchen 7 53578 Windhagen Phone +49 2645 972487 Fax +49 2645 972489 rolf.geppert@fsb.de</p>	<p>15 F+W Kooperations GmbH Zeppelinstraße 10 73760 Ostfildern-Kemnat Phone +49 711 459976-0 Fax +49 711 459976-50 buero.bw@fw-kooperation.de</p>	<p>14, 16 Georg Mark Siegritz 15 92681 Erbendorf Portable +49 171 5663574 Fax +49 5272 608-303 georg.mark@fsb.de</p>	<p>Ralf Frischemeier Sales departement Nieheimer Straße 38 33034 Brakel Phone +49 5272 608-213 Fax +49 5272 608-313 ralf.frischemeier@fsb.de</p>
<p>10 + 11 Karlheinz Peters GmbH Ronald Gerstner Martinstraße 27 63533 Mainhausen Phone +49 6182 9375-0 Fax +49 6182 9375-75 www.kh-peters.de gerstner@kh-peters.de</p>	<p>16 Fuchs + Heckmeier GmbH Wallbergstraße 3 82024 Taufkirchen Phone +49 89 89066-188 Fax +49 89 89066-288 www.fuchs-heckmeier.de info@fuchs-heckmeier.de</p>	<p>15, 16 Herbert Prübner Mittelriedstraße 12 89312 Günzburg Portable +49 160 96382300 Fax +49 8221 9696999 herbert.pruebner@fsb.de</p>	<p>Architectual Consultant Wolfgang Reul Nieheimer Straße 38 33034 Brakel Phone +49 5272 608-127 Fax +49 5272 608-327 wolfgang.reul@fsb.de</p>

Sales Organisation International

Austria
Guth GesmbH
Pulvermühlstr. 3
A-4040 Linz / Donau
Phone +43 732 254119
Fax +43 732 250811
guth@fsb.de

Australia
Halliday & Baillie Pty. Ltd.
The Stables, 1 Ridge Street
Surry Hills, NSW 2010
AU-Sydney
Phone +61 2 96993330
Fax +61 2 96993660
tanya@hallidayandbaillie.com

Bahrain
Elames B.S.C. (c)
P.O. Box 26095
BH-Manama
Phone +973 17 701166
Fax +973 17 700574
servo@behzad-group.com

Belgium
Didier Baert
Brugsestraat 151
B-8020 Oostkamp
Phone +32 50 822082
Fax +32 50 822028
didier.baert@fsb.de

China
FSB Asia Ltd.
Shanghai Rep. Office
CN-Shanghai
Phone +86 21 6217 8840
Fax +86 21 6217 8740
shanghai@fsb.de

Czech Republic
EFB, spol. s.r.o.
Kordacova 1844
CZ-Kladno 272 04
Phone +420 312 687684
Fax +420 312 687685
efb@fsb.cz

Estonia
AS Valnes
Pärnu mnt 139E/4
EE-11317 Tallinn
Phone +372 6565 485
Fax +372 6565 486
valnes@valnes.com

Finland
Inno-Tuote OY
Tähdennontie 9
FI-02240 Espoo
Phone +358 9 8870380
Fax +358 9 88703833
info@inno.fi

France
F+W France SARL
6, Rue de la Maison Rouge
Bâtiment D
F-77185 Lognes
Phone +33 1 60951623
Fax +33 1 60064197
info@fw-france.fr

Greece
Saliveros S.A.
92 - 94 Antigonis Str.
GR-10442 Athen
Phone +30 210 5150001
Fax +30 210 5143926
saliveros@saliveros.gr

Hong Kong
Barwin Metal Co. Ltd.
Unit 2, 10th Floor
Eastern Harbour Centre
28 Hoi Chak Street, North Point
HK-Hong Kong
Phone +852 25626899
Fax +852 25166937
info@barwinmetal.com.hk

Iceland
Velar OG Verkfaeri EHF
Skutuvogur 1 C
Postbox 865
IS-104 Reykjavik
Phone +354 550 8500
Fax +354 550 8501
bjorn@vv.is

Iran
Farapan Industry Co.
No. 22
Nili St.
Sazman Ab Ave. Abali Road
IR-Teheran
Phone +98 21 77000288
Fax +98 21 77007700
info@farapan.com

Ireland
Perrem Design Hardware
Imp&Exp Agencies (IRL) Ltd.
Unit 48, Park West Enterprise
Business & Industrial Park
Nangor Road
IE-Dublin 12
Phone +353 1 6232390
Fax +353 1 6232603
philip.perrem@fsb.de

Italy
Renato Dimpflmeier
Via C.G. Bertero 37
I-00156 Roma
Phone +39 06 86890841
Fax +39 06 82083420
renato.dimpflmeier@fsb.de

Italy/South Tyrol
Guth GesmbH
Pulvermühlstr. 3
A-4040 Linz / Donau
Phone +43 732 254119
Fax +43 732 250811
guth@fsb.de

Japan
Yamagiwa Corporation
1-5-10, Sotokanda
Chiyoda-ku
JP-Tokyo, 101-0021
Phone +81 35692-5233
Fax +81 35692-5236
yamagiwa-i-dev@yamagiwa.co.jp

Latvia
SB & Partneri SIA
Rencenu iela 21
LV-1073 Riga
Phone +371 7113070
Fax +371 7245799
sabine.betz@fsb.de

Lithuania
 UAB "Alfasta"
 Draugystes 17
 LT-3031 Kaunas
 Phone +370 37 764446
 Fax +370 37 764445
 alfasta@takas.lt

Luxembourg
 Arnold Reinstädler
 Inh. Alexander Reinstädler
 Kirchendell 39
 D-66787 Wadgassen-Differten
 Phone +49 6834 9601-0
 Fax +49 6834 9601-18
 alexander.reinstaedtler@fsb.de

Malaysia
 Greifen Marketing (M)
 SDN BHD
 S1-00-18, Pangsapuri Sutramas
 Pesiaran Puchong Jaya Selatan
 Puchong Jaya
 MY-47100 Selangor DE
 Phone +603 8076 4890
 Fax +603 8076 3890
 greifen@tm.net.my

Netherlands
 F+W Nederland B.V.
 Landauer 29
 NL-3897 ABZeewolde
 Phone +31 36 5225688
 Fax +31 36 5226141
 info@fw-nederland.nl

New Zealand
 Halliday & Baillie Ltd.
 P.O. Box 99 579
 NZ-Newmarket, Auckland
 Phone +64 9 3581172
 Fax +64 9 3581176
 sales@hallidaybaillie.com

North America
 FSB Inc.
 1 Bishop Lane
 US-Madison CT 06443
 Phone +1 203 4044 700
 Fax +1 203 4044 710
 info@fsbusa.com

Poland
 Slawomir Bednarczyk
 ul. Radiowa 1/18
 PL-01-485 Warszawa
 Phone +48 22 8618757
 Fax +48 22 8618757
 SBednarczyk@fsb.de

Qatar
 Tadmur Contracting and
 trading Est
 P.O. Box 6984
 QA-Doha
 Phone +974 46 65501
 Fax +974 46 78297
 bmm@tadmur.com

Russia
 Roman Antaschkewitsch
 Dirizhabelnaja ul, 13, a/ja 111
 RU-141700 Dolgoprudnij, MO
 Phone +7 916 2333477
 Fax +7 498 6009728
 roman.antaschkewitsch@fsb.de

Singapore
 Yong Hup Hardware (Pte) Ltd
 115 King George's Avenue,
 #01-01
 SG-Singapore 208561
 Phone +65 62960111
 Fax +65 62971481
 yhprojec@singnet.com.sg

South Africa
 Global Building
 Elements (Pty) Ltd
 PO Box 3953
 ZA-Honeydew, 2040
 Phone +27 11 9572114
 Fax +27 11 9572116
 info@gbe.co.za

South-Eastern Europe
 (AL, BA, BG, CS, HR, HU,
 MD, MK, RO, SI, SK)
 Enikö Bucs
 Regional Sales Manager
 Oberfeldstraße 24
 A-5082 Grödig
 Phone +43 6246 72226-151
 Fax +43 6246 72226-145
 enikoe.bucs@fsb.de

South Korea
 Nam Hwa Trading Co. Ltd.
 551-2, Sinsa-Dong
 Gangnam-Gu
 KR-Seoul
 Phone +82 2 5116085
 Fax +82 2 34434401
 namhwa-tr@hanmail.net

Spain
 New Lock Systems S.A.
 Calle Freixa, 37 Bajos
 E-08021 Barcelona
 Phone +34 93 4144041
 Fax +34 93 4142276
 admin@newlocksystems.es

Sweden
 Boxbeslag Designer Fittings AB
 P.O. Box 500
 S-551 17 Jönköping
 Phone +46 36 361601
 Fax +46 36 361629
 johanna@bxbdesign.se

Switzerland
 Martin Küpfer
 Rifeldweg 12
 CH-4322 Mumpf
 Phone +41 79 2428941
 Fax +41 62 8734387
 martin.kuepfer@fsb.de

Thailand
 J.N.V. International Supplies Co.
 230 Thosapol Land 2 Bldg.
 12th Fl.
 Ratchadapisek Road
 Huaykwang
 TH-Bangkok 10310
 Phone +662 692 84702
 Fax +662 692 8473
 jnvinter@yahoo.com

Turkey
 En Ithalat Ihracat Mumessillik
 Semsettin Gunaltay cad
 No. 12 - 13
 TR-Kazasker-Istanbul
 Phone +90 216 4784796
 Fax +90 216 4784799
 ebru.bozova@fsb.de

United Arab Emirates
 Metallic Equipment Co.
 Head Office
 P.O. Box 548
 AE-Abu Dhabi
 Phone + 971 2 6344765
 Fax + 971 2 6326732
 basel.moghrabi@fsb.de

United Kingdom
 Allgood plc
 297 Euston Road
 GB-London NW1 3AQ
 Phone +44 20 73879951
 Fax +44 20 73872549
 info@allgood.co.uk

FSB-Edition

The following titles have so far appeared in the FSB Edition:

- Greifen und Griffe**
Otl Aicher, Robert Kuhn
Köln: Verlag der Buchhandlung Walther König, 1987
- Türklinken**
Workshop in Brakel
Texte: Otl Aicher, Jürgen W. Braun, Siegfried Gronert
Fotos: Timm Rautert
Köln: Verlag der Buchhandlung Walther König, 1987
- Johannes Potente, Brakel**
Design der 50er Jahre
Texte: Otl Aicher, Jürgen W. Braun, Siegfried Gronert, Robert Kuhn, Dieter Rams, Rudolf Schönwandt
Köln: Verlag der Buchhandlung Walther König, 1989
- Zugänge – Ausgänge**
Gedichte von Peter Maiwald sowie Textbeiträge von Jürgen W. Braun und Marcel Reich-Ranicki
Köln: Verlag der Buchhandlung Walther König, 1989
- Zugänge – Ausgänge**
Fotos von Timm Rautert sowie Textbeiträge von Otl Aicher, Jürgen Becker, Wolfgang Pehnt
Köln: Verlag der Buchhandlung Walther König, 1990
- Türdrücker der Moderne**
Eine Designgeschichte von Siegfried Gronert
Köln: Verlag der Buchhandlung Walther König, 1991
- Annentag in Brakel**
Ein deutsches Volksfest
Fotos: Rudi Meisel, Timm Rautert, Michael Wolf
Reportage: Bernd Müllender
Weitere Beiträge: Eugen Drewermann, Herbert Engemann, Peter Maiwald
Köln: Verlag der Buchhandlung Walther König, 1992
- Übergriff**
Auftragstellung: Jürgen W. Braun
Realisation: Studenten der HfG Karlsruhe unter Leitung von Gunter Rambow
Texte: Peter Sloterdijk, Heinrich Klotz, Jürgen W. Braun
Köln: Verlag der Buchhandlung Walther König, 1993
- Das Türklinken-Chaos**
The Doorhandle Disaster
Le chaos de la poignée de porte
Erzählung und Bilder von Klaus Imbeck
Köln: Verlag der Buchhandlung Walther König, 1994
- Visuelle Kommunikation**
Bausteine, Realisationen
Texte: Otl Aicher, Sepp Landsbek, Jürgen W. Braun
Köln: Verlag der Buchhandlung Walther König, 1995
- Hand und Griff**
Ausstellung Wien 1951
Walter Zeischegg, Carl Auböck
Ein Buch über Griffpioniere von Andrea Scholtz
Köln: Verlag der Buchhandlung Walther König, 1995
- Gesten**
Ein Buchprojekt von Fotografie-Studenten der Hochschule für Grafik und Buchkunst Leipzig unter der Leitung von Timm Rautert
Köln: Verlag der Buchhandlung Walther König, 1996
- Vom Mythos des Funktionalismus**
Bernhard E. Bürdek, Reinhard Kiehl, Florian P. Fischer, Jürgen W. Braun
Zeichnungen: Reinfriede Bettrich, Pfronten, Hans Hollein, Wien
Köln: Verlag der Buchhandlung Walther König, 1997
- Das virtuelle Haus**
Dokumentation eines Workshops mit: Peter Eisenmann, Jacques Herzog, Toyo Ito, Daniel Libeskind, Jean Nouvel u. a.
Köln: Verlag der Buchhandlung Walther König, 1998
- Links – Rechts**
Ein Buch über Händigkeit von Andrea Scholtz
Köln: Verlag der Buchhandlung Walther König, 1999
- Le Corbusiers Hände**
Les Mains de Le Corbusier
Essaysammlung von André Wogenscky
Köln: Verlag der Buchhandlung Walther König, 2000
- Die Sprache der Hände**
Ein Lese- und Blätterbuch mit den besten Beiträgen aus der FSB-Edition, zusammengestellt und kommentiert von Jürgen W. Braun, herausgegeben von FSB Verlag Hermann Schmidt Mainz, 2006
ISBN 3-87439-695-9

Literature FSB

Other books from “the publishers sidelining in handles”:

Wege zur Architektur 1
Atmosphären
Peter Zumthor
Privatdruck, 2004

Wege zur Architektur 2
Architektur und Gedächtnis
Mario Botta,
Brigitte Labs-Ehlert
Privatdruck, 2005

Einfach!
Architektur aus Österreich
Walter Chramosta, Manuela
Hötzl, Bart Lootsma, Antje
Mayer, Jan Tabor, Ute Woltron
Graz: Verlag Haus der
Architektur, 2006

Wege zur Architektur 3
Rundbau in Hombroich
Oliver Kruse,
Brigitte Labs-Ehlert
Privatdruck, 2006

Wege zur Architektur 4
Struktur und Kreativität
Robert Wilson,
Jürgen W. Braun
Privatdruck, 2007

