

FSB Clamping Rose Fastening

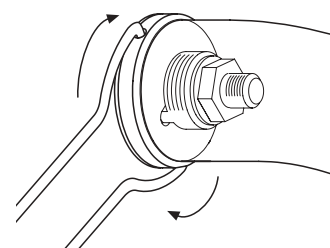

The FSB clamping rose fastening is a new method of assembling door-pulls whereby the pull is tightened fast against the surface of the door. Visible fixing screws are done away with.

All door pulls with round necks are supplied as female parts with an internal left-handed thread 18 by 1.5 mm (M8 fixing) or 14 by 1.5 mm (M6 fixing). A clamping rose fastening comprises a plastic washer, a steel washer, a clamping element, a rotating rose and a spacer sleeve that are securely held in place by a plastic clip and pre-attached to the end of the handle.

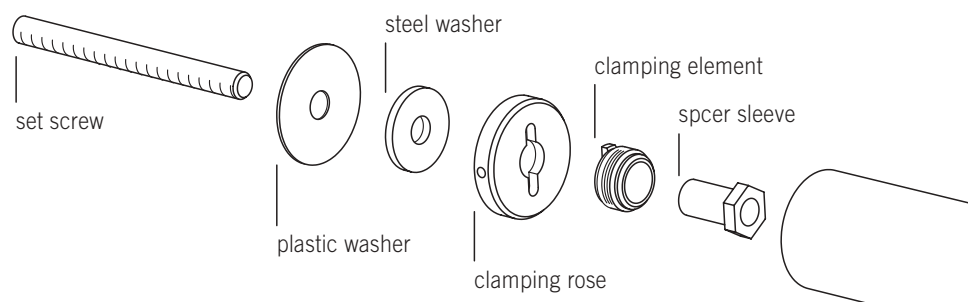

FSB Clamping Rose Fastening

The new FSB clamping rose fastening allows all FSB door pulls with round necks to be screwed tight against the surface of the door by means of an easy-to-operate clamping rose. Radial play allowed for by FSB ensures the necessary tolerances during fitting. Assembly is as follows:

Step 1

First fit into the door the set screw over which the clamping elements are to pass. How this is done depends on whether back to back fixing, bolt through-fixing or secret single side fixing with expansion plug.

Step 2

Then detach the clamping elements from the handle ends by turning them anticlockwise. Remove the plastic clip and slip the plastic washer, the steel washer, the clamping rose and the clamping element over the set screw in that order. Using the spacer sleeve, screw the elements together, ensuring that the clamping rose and clamping element remain free to rotate.

Step 3

Place the handle on the fixing points and tighten against the door by alternately turning the clamping roses in a clockwise direction.

A turning device for the FSB clamping rose is supplied with the product.